

# Simone Development signs Affinity Health Plan for Metro Center Atrium

**THE WESTCHESTER BLOG** Ernie Garcia, [elgarcia@lohud.com](mailto:elgarcia@lohud.com) 11:27 a.m. EDT July 17, 2014

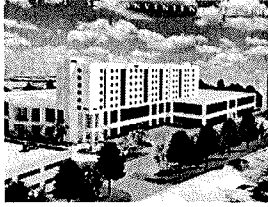

Simone Development Companies (<http://www.simdev.com/>) announced Thursday that Affinity Health Plan will lease 95,000 square feet at its Metro Center Atrium (<http://www.hutchmetrocenter.com/atrium.html>) in the Bronx.

It's the latest tenant for Simone, which is currently finishing a new building for the WESTMED Medical Group (<http://www.westmedgroup.com/>) at 3030 Westchester Ave. in Purchase.

"With the addition of Affinity Health Plan, the Metro Center Atrium is approaching full occupancy, making it one of the most successful new commercial real estate developments in the region. This is great news for the Bronx which is enjoying an unprecedented economic renaissance," said Joseph Simone, President of Simone Development Companies.

Simone, a Purchase resident, described his leasing activity in the past six months as "phenomenal."

Among the other healthcare tenants recently signing leases at the complex include Montefiore Medical Center, Calvary Hospital, Fresenius Medical Care North America, Hanger Prosthetics, Parkchester Oral & Maxillofacial Surgery and Ophthalmologist Dr. Eric Wolf.

The Metro Center Atrium is a 370,000-square-foot office/retail/hotel complex that is nearing completion at Simone's 42-acre, multi-building Hutchinson Metro Center campus.

Twitter: [@Ernie\\_G\\_journo](https://twitter.com/Ernie_G_journo) ([https://twitter.com/Ernie\\_G\\_journo](https://twitter.com/Ernie_G_journo))

Read or Share this story: <http://lohud.us/1mRaD4S>



## MORE STORIES

[New Rochelle awarded nearly \\$2 million for Sandy fixes](#)  
([/story/news/politics/2014/07/29/f](#)